

LM14 SERIES

ARCHITECTURAL SURFACE MODULE 1X4 LED VOLUME LUMINAIRE



FEATURES

- Surface module full size 1X4 ambient LED luminaire featuring a single linear high transmission acrylic diffuser.
- For use where recessing is not possible or desirable, or when high ceilings necessitates suspending down to reasonable heights.
- Larger-scale rounded diffuser envelopes the LED light source allowing maximum light transmission while eliminating pixilations and hot spots.
- Delivers a balanced amount of horizontal and vertical illumination.
- Digital LED technology provides high efficacy and energy efficiency.
- Multiple power and light levels are offered as standard to allow meeting design and energy needs per application. Custom factory set levels available on request.
- Lumen maintenance; Reported L70 (hours) & L80 (hours) > 60,000.
- CRI greater than 80.
- Fixture lumens per watt ratios up to 112.
- American Made.
- Matching recessed luminaire: LR14 Series.

CROSS SECTIONS

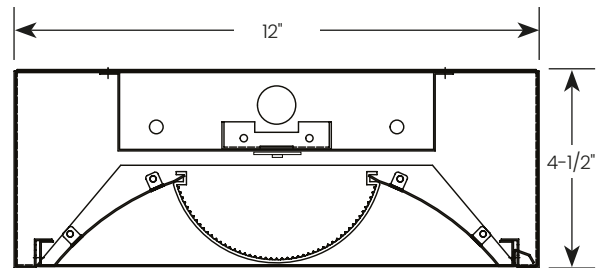

HANGING ACCESSORIES

PART #	DESCRIPTION
R5PF-100	Round 5" power feed canopy, Hanging hardware, 100" long 1/16" cable.
S5PF-100	Square 5" power feed canopy, Hanging hardware, 100" long 1/16" cable.
R5-100	Round 5" canopy, Hanging hardware, 100" long 1/16" cable.
R2-100	Round 2" canopy, Hanging hardware, 100" long 1/16" cable.
S5-100	Square 5" canopy, Hanging hardware, 100" long 1/16" cable.
S2-100	Square 2" canopy, Hanging hardware, 100" long 1/16" cable.
VH-XX	"V" Hanger w/XX=48"L or 72"L Chain & "S" Hock
CPYS-1	S-1 Single Stem 5" Dia. Canopy
STMXX	XX=12"L, 24"L, 48"L Stem/ 3/8" IPS-5/8" OD

Other cable and stem lengths available. Consult factory.



Fixture type:	Job information:

LM14 SERIES

ARCHITECTURAL SURFACE MODULE 1X4 LED VOLUME LUMINAIRE



PRODUCT DEFINITION SHEET

Ex: LM5-14M-6400-35K-1%-UNI-EM7



1	2	3	4	5	6
SERIES	MODULE SIZE/CEILING	NOMINAL LUMENS	COLOR TEMP	DRIVER	VOLTAGE
<input type="checkbox"/> LM14	<input type="checkbox"/> 14M 1X4 Surface Module.	<input type="checkbox"/> 3300 <input type="checkbox"/> 3800 <input type="checkbox"/> 4200 <input type="checkbox"/> 4500 <input type="checkbox"/> 5000 <input type="checkbox"/> 6400 <input type="text" value="XXXX"/> Custom Lumen Package Contact Factory	<input type="checkbox"/> 30K <input type="checkbox"/> 35K <input type="checkbox"/> 40K <input type="checkbox"/> 50K Upon Request	<input type="checkbox"/> 1% 0-10V 1% Dimming <input type="checkbox"/> - As specified	<input type="checkbox"/> UNI

7	8
STANDBY LIGHTING OPTIONS	OPTIONS
<input type="checkbox"/> EM5 <input type="checkbox"/> EM7 <input type="checkbox"/> EM10 <input type="checkbox"/> EM12	<input type="checkbox"/> As Needed

MODULE SIZE 2X4

Nominal Lumen Package	Color	Fixture Power (W)	Delivered Lumens	Fixture LPW	Standby Lighting Option
3300	3000K	30	3122	103	✓
3300	3500K	30	3182	105	✓
3300	4000K	30	3294	108	✓
3300	5000K	30	3409	112	✓
3800	3000K	37	3666	100	✓
3800	3500K	37	3735	101	✓
3800	4000K	37	3867	105	✓
3800	5000K	37	4002	109	✓
4200	3000K	41	4010	98	✓
4200	3500K	41	4086	99	✓
4200	4000K	41	4230	103	✓
4200	5000K	41	4378	107	✓
4500	3000K	45	4286	96	✓
4500	3500K	45	4368	98	✓
4500	4000K	45	4522	101	✓
4500	5000K	45	4680	105	✓
5000	3000K	51	4775	93	✓
5000	3500K	51	4866	95	✓
5000	4000K	51	5037	98	✓
5000	5000K	51	5213	102	✓
6400	3000K	65	6097	93	✓
6400	3500K	65	6213	95	✓
6400	4000K	65	6431	99	✓
6400	5000K	65	6656	102	✓



Detail

Actual wattage may differ by +/- 5% when operating between 120V-277V +/- 10%.

LM14 SERIES

ARCHITECTURAL SURFACE MODULE 1X4 LED VOLUME LUMINAIRE



LED MODULES

- High performance linear configured LED module boards.
- Each board consists of multiple mid-power, high efficacy LEDs in a precise layout eliminating the need for supplemental heat sinking.
- The boards produce an even and diffuse light which maximizes optical efficiency.
- Compatible with the dimming performance of the LED driver.
- Color temperatures available: 3000K, 3500K and 4000K.
- Upon request: 5000K.

LED DRIVERS

- Factory programmable constant current LED power supply.
- Multiple standard drive current outputs (factory set by Mercury) are cataloged with their corresponding lumen package offerings. Upon request, custom drive current outputs and lumen packages are available.
- Universal voltage input, 120V-277V, 50HZ-60HZ.
- Specification grade dimming down to 1% on 0-10V dimming controls.
- Optional pre-configured drive current drivers are available. Non-dimming.

LED LUMEN PACKAGES

- Cataloged standard lumen packages. See attached chart for full details.
- Custom lumen packages pre-set are optional. Contact factory for details.

HOUSING

- All metal parts are fabricated in a computer controlled operation from heavy gauge code grade cold rolled steel.
- Rivets and/or spot welds hold all parts for strength.
- Unique hinging and latching system allows interior components and diffuser to hinge down or be removed for easy installations.
- A custom formulated non-glare white powder coating is applied to the housing after fabrication providing a reflectivity of at least 90%.

DIFFUSER

- Architecturally-curved profile design.
- Extruded from custom formulated high transmission acrylic material.
- Linear ribbing for high LED performance.

STANDBY LIGHTING OPTIONS

- Self contained module, 5W, 7W, 10W or 12W as specified. Battery backup upon loss of power.
- May not be available with some higher lumen packages. See Lumen package matrix.

INSTALLATIONS

- Designed for surface mounting direct to most ceiling types.
- May be suspended on auxiliary hanging hardware.
- Sufficient knockouts are provided on the back of the housing for all electrical connections.
- Blind knockouts on the ends for surface conduit entry.

CERTIFICATE OF SAFETY COMPLIANCE AND LISTINGS

- Luminaire: UL and CUL listed 1598 and bears their label. Suitable for dry locations or optional damp locations with UL Damp Label.

WARRANTY

- 5-year limited warranty is standard. Special 10-year warranty available on a job-to-job basis. Complete LED warranty terms available at www.mercltg.com
- Actual performance may differ as a result of end-user environment and application.
- Most LED luminaires are suitable to operate in ambient temperatures from -20C (-4F) to 25C (77F).
- The following exclusions apply: Luminaires with standby lighting option, integral lighting controls options, or wireless control options. Consult factory.
- LM-79 testing was measured under a controlled 25C (77F) ambient operating temperature.

PHOTOMETRICS

- All photometrics reports are available at www.mercltg.com