

 **WARNING**

1. Don't use in location that exists with vibration, impact corrosion or flammable gas and dust.
2. Don't use in location that is in high temperature as like sauna.
3. Only use designated LED.
4. Don't modify and change assembly of luminaires.
5. Do not turn on when lighting fixture is damaged.
6. Connect power source line to LED driver certified according to en/iec 607 42.

 **CAUTION**

1. When removing or attaching the reflector, do not touch it with bare hands.
(Clean gloves or new gloves should be used as fingerprints may be left on the reflector)
2. The luminaire is not suitable for outdoor installation.
3. To avoid fire and electric shock hazards, if this luminaire has damaged external flexible wiring, it should only be replaced by the manufacturer or its service agent.
4. Use a soft, damp cloth; and a standard nonalcoholic, pHneutral detergent.
Make sure of the color of the wires : (+) red, (-) black.
5. The luminaire must be turned off and cool before cleaned.
Note : Periodic cleaning is essential. The interval and method will depend on the mounting location, mounting situation and ambient conditions.
6. Do not connect to the branch circuit with other lighting fixtures which have different light source like discharge lamp & etc.



This marking shown on the product or its literature, indicates that it should not be disposed with other household wastes at the end of its working life. To prevent possible harm to the environment or human health from uncontrolled waste disposal, please separate this from other types of wastes and recycle it responsibly to promote the sustainable reuse of material resources.

Household users should contact either the retailer where they purchased this product, or their local government office, for details of where and how they can take this item for environmentally safe recycling.
Business users should contact their supplier and check the terms and conditions of the purchase contract, This product should not be mixed with other commercial wastes for disposal.

 **SAFETY MARKS**



The luminaire must not under and circumstances be covered with heat insulating covers or similar materials.

※ Before you use, please read this information and use correctly.



Product Family: AURORA

INSTALLATION INSTRUCTIONS SAFETY INFORMATION

Luminaire Assembly **ARA-13-AD-FLT**

※ To change size depending on options.

THE ELECTRICAL CONNECTION MUST BE MADE BY AN ELECTRICIAN

MAKE SURE THE POWER SUPPLY IS TURNED OFF AT THE FUSE BOARD BEFORE MAKING THE ELECTRICAL CONNECTION.

THE ELECTRICAL CONNECTION AND INSTALLATION CAN BE DONE FROM THE ROOM.

ELECTRICAL CONNECTIONS:

1. Open the junction box
2. Connect the wires coming out of the junction box to the power supply accordingly.

Black - voltage
White - neutral
Green - ground wire



NOTE GROUNDING : Many structures are grounded through steel conduit. In this case, if there is no grounding wire, leave the green wire of the green wire from the fixture unattached.

3. Cover the connections with safety caps.
4. Finally continue with the installation.

► Electrical Connections

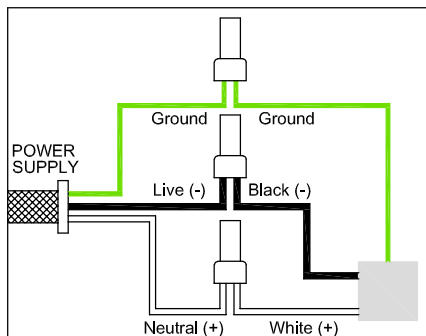

► Wiring Diagram

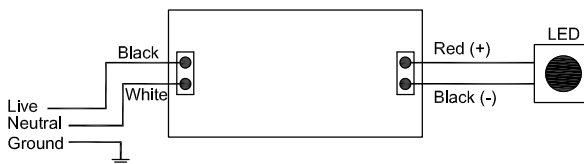

[Connect wires accordingly]

- Black (120-277V) = Supply Voltage
- White = Neutral
- Green or copper wire = Grounding Junction Box Wire

DRIVER CONNECTION AND SPACING

1. Keep the distance between the light fixture and the driver as much as possible.
2. The inside of the ceiling where the lighting fixture is to be installed, it is necessary to secure a minimum space for heat dissipation.

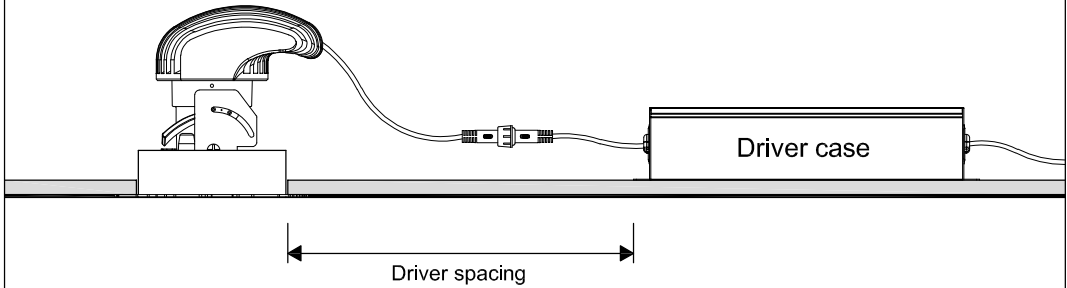

DRIVER ELECTRIC DIAGRAM

1. Detect the heat from the light fixture and lower the temperature.
2. Connect the driver and lighting fixtures through the terminal block.

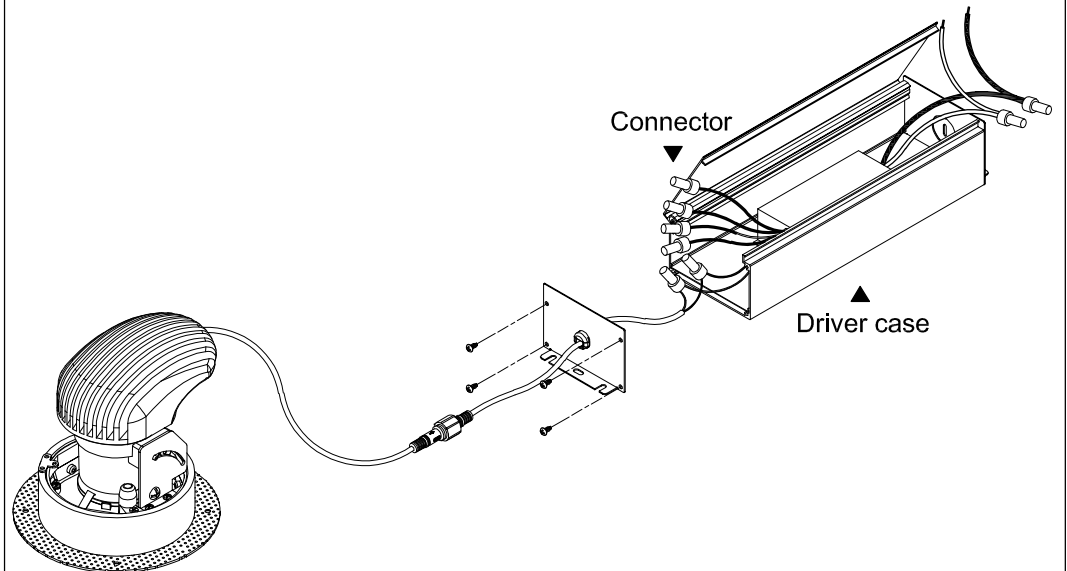

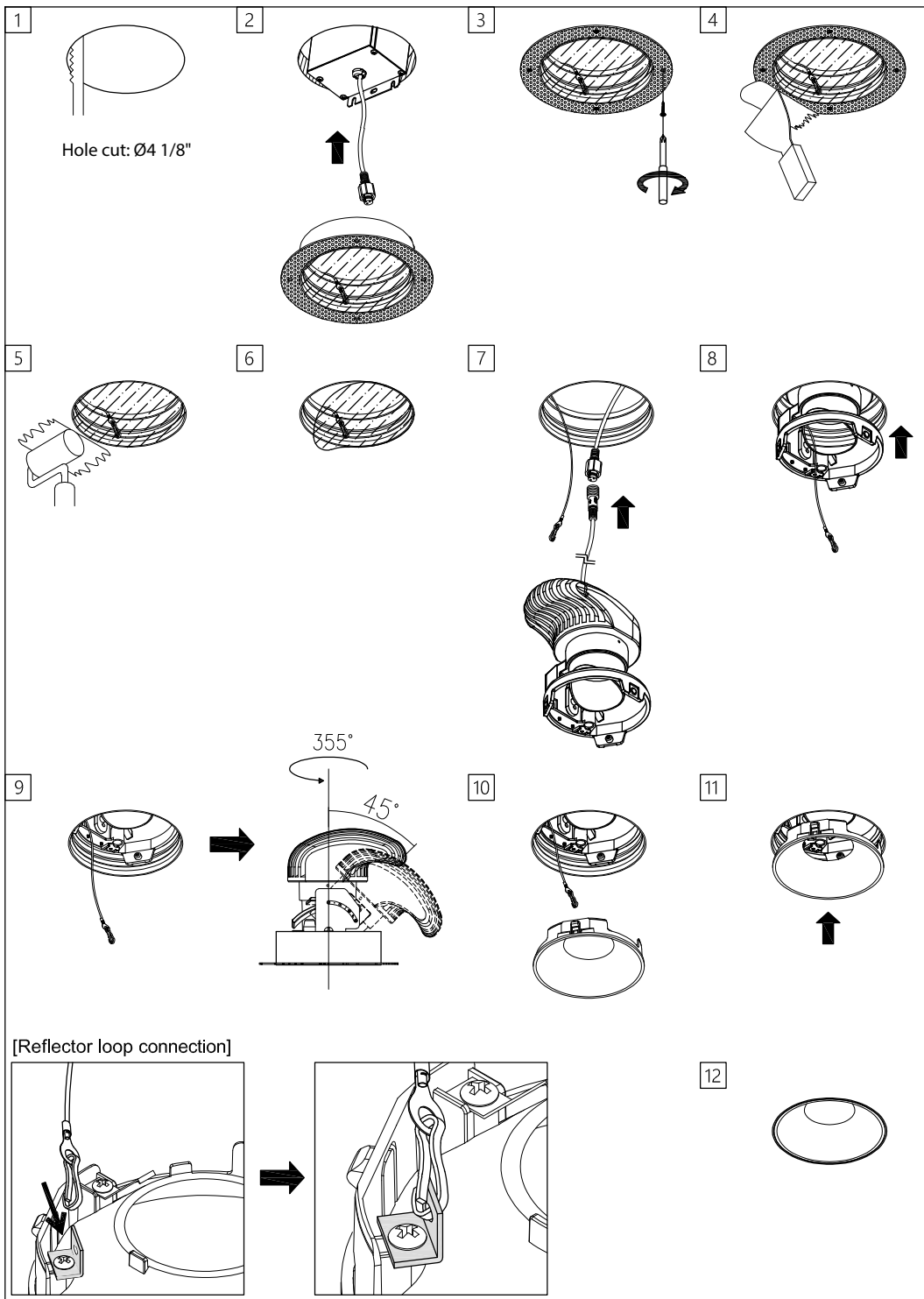

INSTALLATION:

1. Make holes in the ceiling to match the size of the lighting fixture.
2. Insert the outer housing into the perforated ceiling and secure it with countersunk head bolts.
3. Putty the ceiling as shown in the picture and finish with paint.
4. After removing the vinyl attached to the painted outer housing, hang the ring visible on the inside downward.
5. Connect the driver connected to the power (AC120) line and the line connected to the lighting fixture and push it into the ceiling, Connect it to the housing and check for a clicking sound.
(※ Be sure to check whether the device is completely fixed.)
6. After confirming that the body of the light fixture is completely fixed, insert the screwdriver into the part shown in the picture and turn it to adjust to the desired angle.
7. After adjusting the angle, connect the reflector to the hook hanging down and finally attach the reflector to the lighting fixture.
(※ Be sure to attach a safety ring to the reflector!)
(※ When attaching the reflector to the lighting fixture, align and secure it well to avoid pinching the wire.)
(※ Be sure to hold the reflector with a clean cloth or gloves to minimize stains.)

[How to adjust the angle and replace accessories after installation]

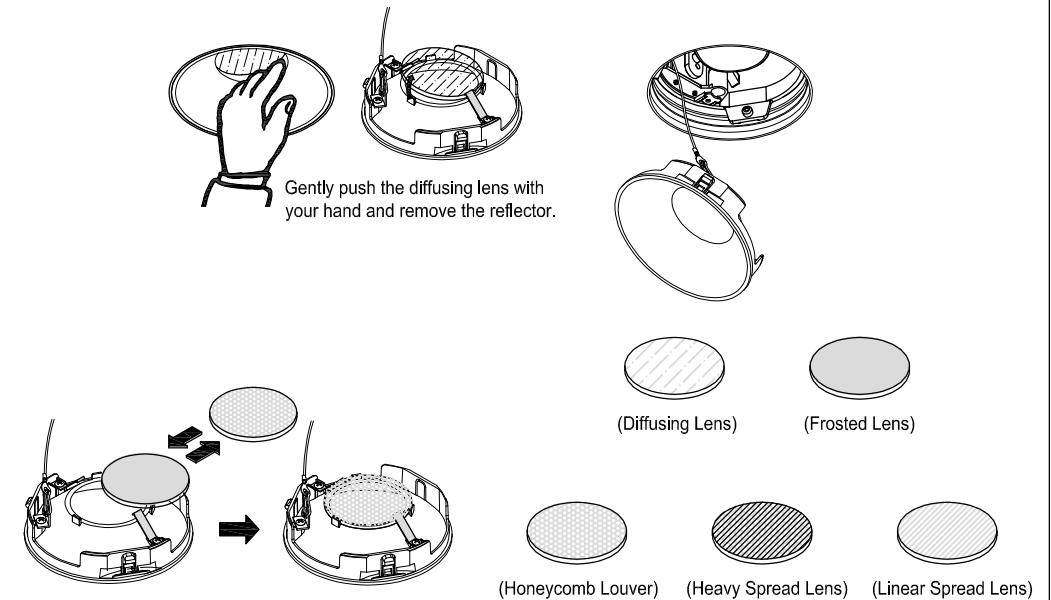

1. Remove the reflector from the lighting fixture and separate the reflector connected to the wire.
2. Hang the separated reflector while connected to the ring and adjust the desired angle with a screwdriver.
3. To replace the filter, slide the desired filter into the bracket attached to the separated reflector, secure it, and then fix it on the lighting fixture.